

**General Notes:**  
 1) Utilities shown are based on surface indications only. Underground utilities are not located. Contractors are to verify locations by calling the Underground Facilities Protective Organization at 1-800-962-7962 and/or local utility companies.  
 2) Subject to any rights of way or easements which may have been granted to utility companies.  
 3) Any certification expressed or implied herein applies only to the individual(s), association(s), agency(s), and/or corporation(s) explicitly listed.  
 4) Copies from the original of this survey map not marked with seal shall not be considered to be a valid true copy.  
 5) Unauthorized alteration or addition to a survey map bearing the seal of a licensed Land Surveyor is a violation of Section 7209, subdivision 2 of the New York State Education Law.  
 6) There has been no delineation of wetlands or hazardous wastes on this property and the existence of such was neither investigated nor confirmed during the course of this survey.  
 7) Reference is made to Filed Map No. 5259, "Lot Split of a Portion of Premises of Railway Reorg. Estate Inc.", by Robert J. Lawson, L.S., dated 03-24-2004.  
 8) Subject to the rights of the public in and to the use of New York State Routes 23 and 7.

- Legend**
- Denotes 1/2" steel rod and cap set
  - Calculated point on property line
  - 5/8" steel rod and cap, found
  - Utility Pole
  - Overhead utility line
  - Parcel Lines or Lot Lines

Lands Now or Formerly of  
 Dylan Wright  
 per Instrument No. 2016-4919  
 Otsego County Tax Parcel No.  
 300.05-4-10



Lands Now or Formerly of  
 Railway Reorg Estate, Inc.  
 (Reputed Owner)  
 per Liber 352 at Page 362  
 Otsego County Tax Parcel No.  
 300.05-4-80.01

Lands Now or Formerly of  
 Thomas Seletti, Jr.  
 per Instrument No. 2011-1479  
 Otsego County Tax Parcel No.  
 300.05-4-11

**LOT II**  
**0.155 ACRES**

**LOT-I**  
**0.155 ACRES**

**0.31 ACRES TOTAL**

**SHOWING LOT SPLIT SURVEY OF LANDS OF**  
**JOHN H. SIENKIEWICZ**  
 PER INSTRUMENT 2011-3718  
 OTSEGO COUNTY TAX PARCEL 300.05-4-80.3  
**CITY OF ONEONTA ~ COUNTY OF OTSEGO**  
**STATE OF NEW YORK**

**MAP**

SCALE: 1" = 20'

No.	Revisions	Description
	Date	

**R. BRAUN, LAND SURVEYOR**  
 Richard Braun, L.S. 50393  
 8 Winkler Road  
 PO Box 31  
 Sidney, NY 13838  
 607-563-2510  
 rbraunsurveyor@gmail.com

*R. Braun*

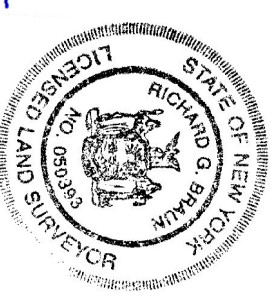

Drawn By: RGB Date: 03-16-22 Scale: 1" = 20' Map No. 5250